

# Solar-powered water pump

Mobile Pro MKII

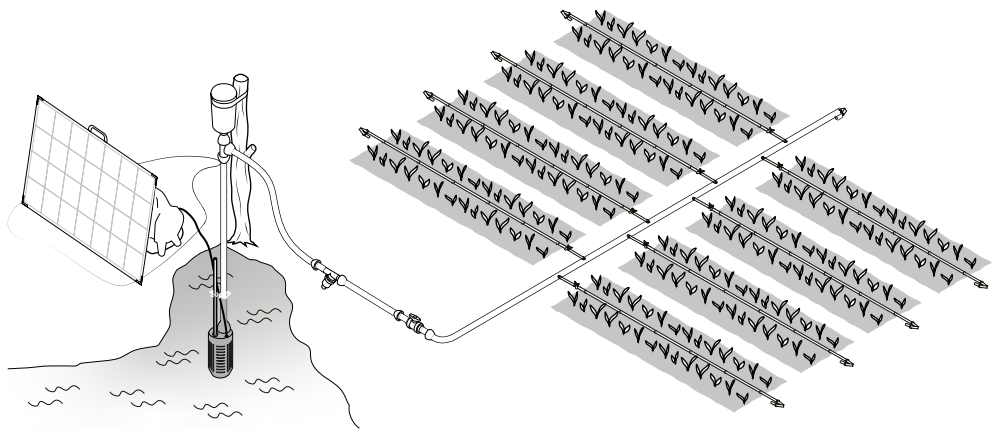

## Drip system manual

# Table of Content

<b>1</b>	<b>How to read this manual .....</b>	<b>3</b>
<b>2</b>	<b>Drip system components .....</b>	<b>4</b>
<b>3</b>	<b>Overview of the drip system.....</b>	<b>5</b>
<b>4</b>	<b>How to install.....</b>	<b>6</b>
4.1	Water filter .....	6
4.2	Main valve .....	8
4.3	Main line.....	9
4.4	Drip line.....	11
4.4.1	Start the system.....	13



# 1 How to read this manual

The manual describes a general installation. For the system to work properly it needs to fulfil different requirements.

In order to better understand the requirements the Spowdi figure helps the reader:



Spowdi figure is happy when it is correct.



Spowdi figure is sad when something is NOT correct.

In the illustrations are different types of arrows:



Change of one state to another.

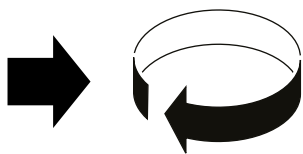

Move according to arrow.



Points out area of interest.

## 2 Drip system components

The components of drip system.

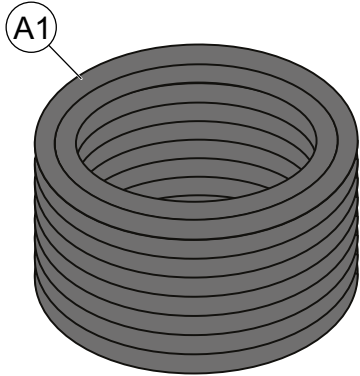

**A1. Main Line**  
Ø25mm, 100m

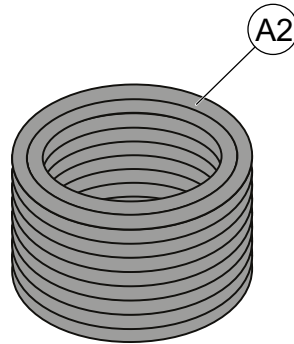

**A2. Drip line**  
Ø16mm, 500m

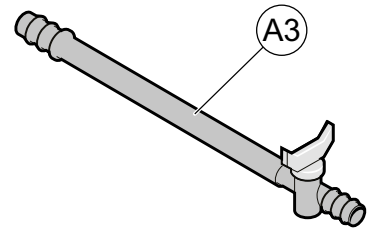

**A3. Drip connector,**  
Ø16mm, 20 pcs

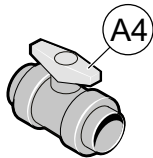

**A4. Main valve. Threaded** Ø25mm, 1 pc

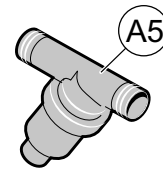

**A5. Water filter,** Ø25mm, 1 pc

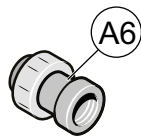

**A6. Female adapter, threaded**  
Ø25mm, 2 pcs

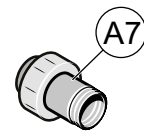

**A7. Male adapter, threaded**  
Ø25mm, 2 pcs



**A8. Main line stopper,** Ø25mm, 1 pc

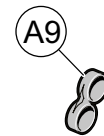

**A9. Drip line stopper,** Ø16mm, 20 pcs

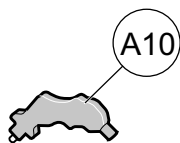

**A10. Multi tool, hole punch** 7.5mm, 1 pc

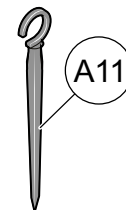

**A11. Drip holder pin,** 40 pcs

# 3 Overview of the drip system

Spowdi Mobile Pro MKII can irrigate 1 acre farmland.  
Drip starter package is for 500sqm farmland.

Spowdi recommends 30m in length for one growing area.

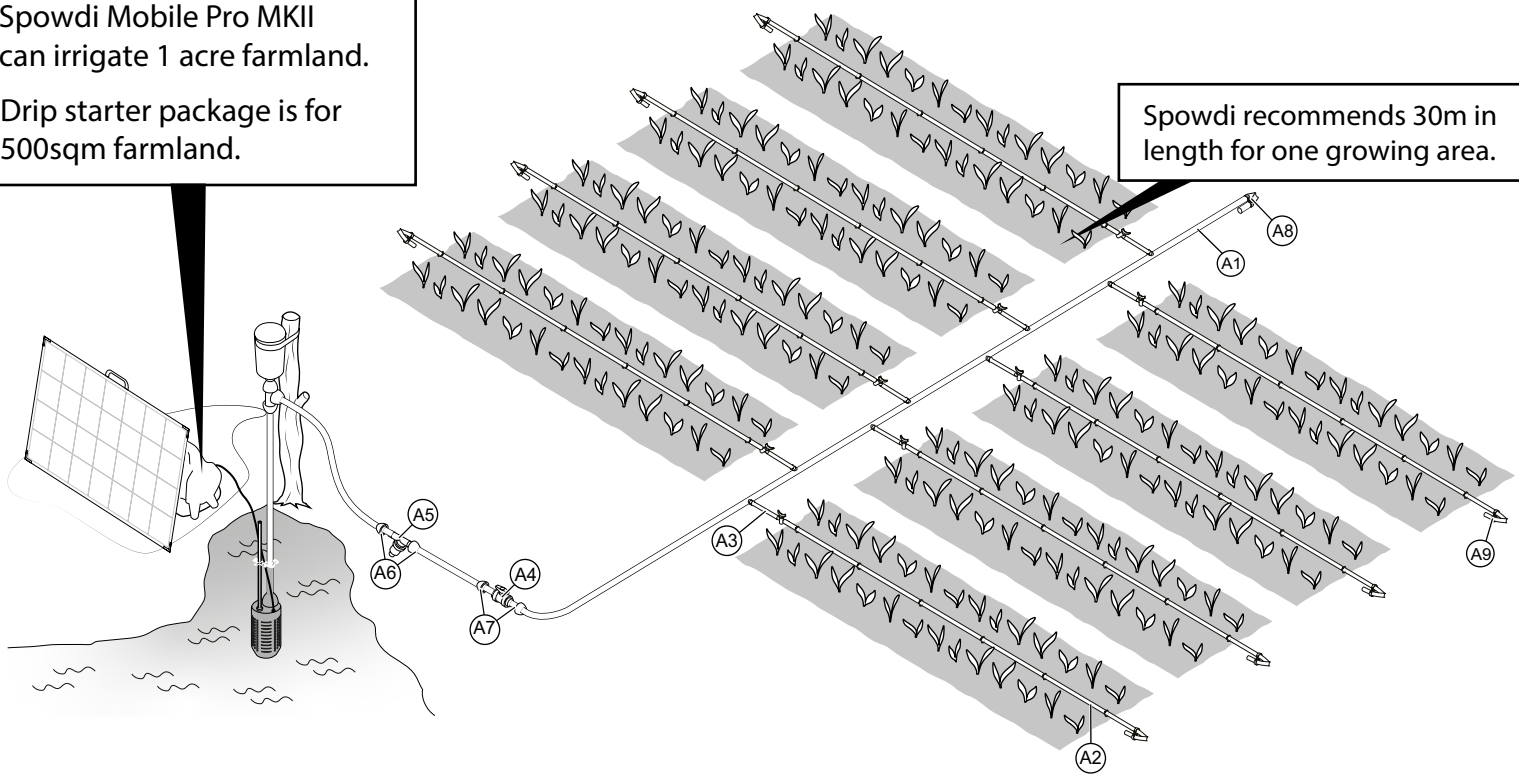

# 4 How to install

## 4.1 Water filter

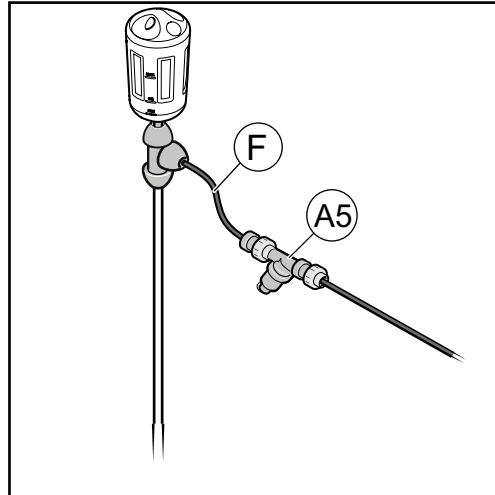

### Connection of water filter to water extraction tube

- 1 See MK II system installation manual for the connection of water extraction tube.
- 2 Remove cap on one of female adapter (A6).
- 3 Take out plastic parts and O-ring as shown in the figure.
- 4 Put cap, plastic parts and O-ring on hose.
- 5 Screw cap anticlockwise to secure hose.

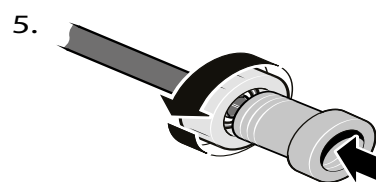
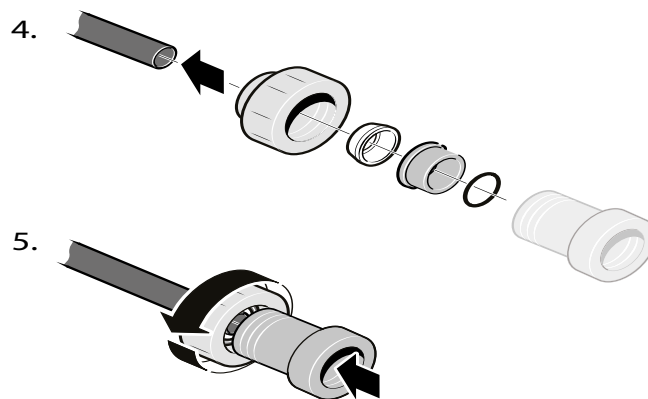
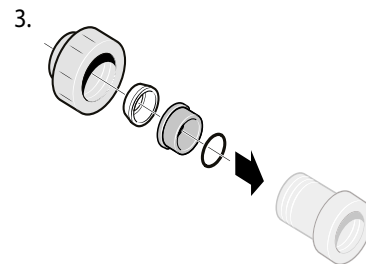
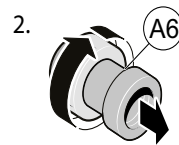

6 Screw water filter (A5) to female adapter (A6) and fasten it. Make sure arrow on water filter is according to direction of water flow.

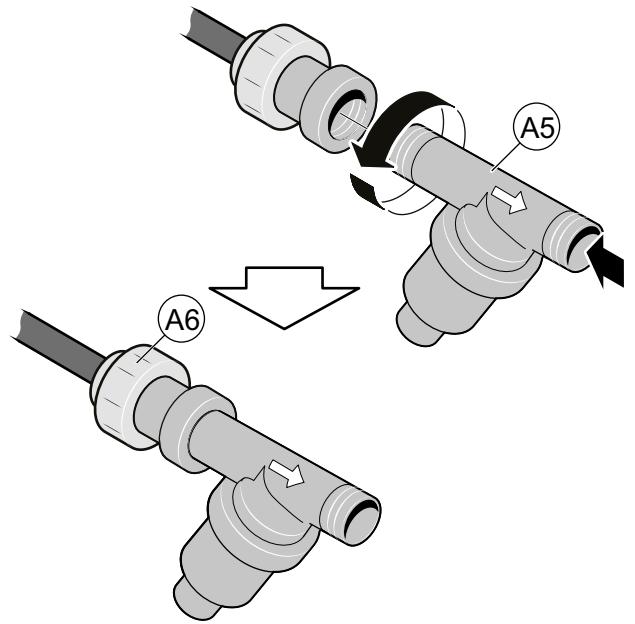

7 Cut one length of 0,5 meter from main line Ø25mm (A1).

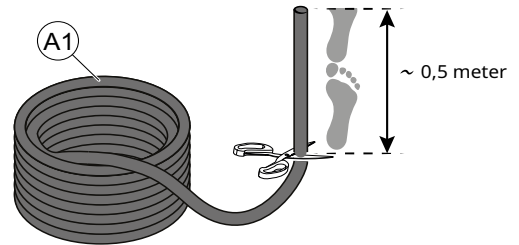

8 Follow the same steps mentioned above to mount another female adapter (A6) on cut length of main line.

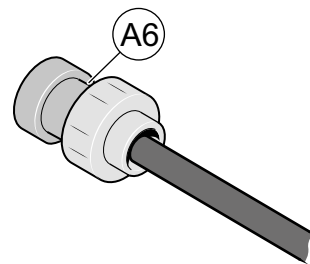

9 Screw female adapter (A6) with hose to water filter (A5).

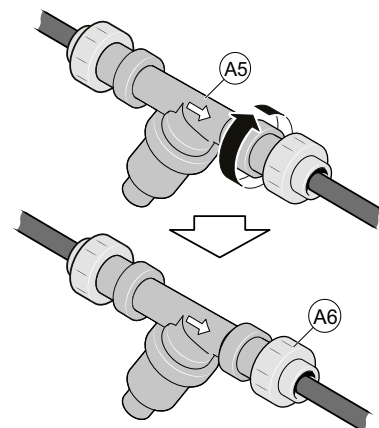

## 4.2 Main valve

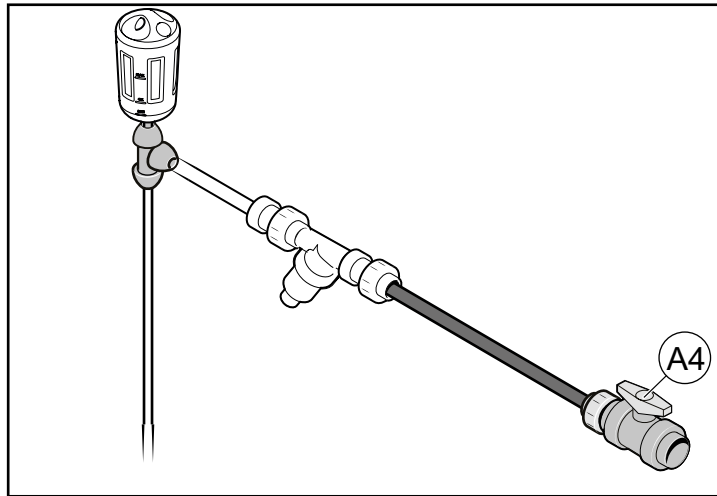

### Connection of main valve to cut main line of water filter

- 1 Take one male adapter (A7), remove cap and follow the procedure same like female adapter (A6).
- 2 Mount a male adapter on main line.
- 3 Screw male adapter (A7) to main valve (A4) and fasten it.

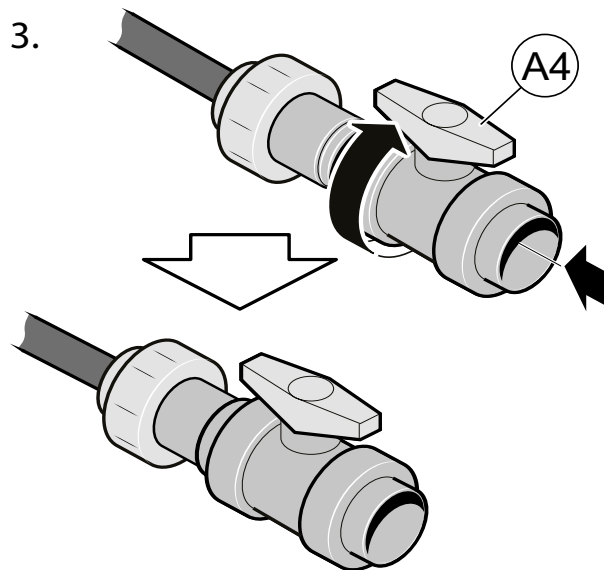
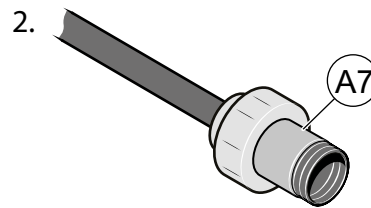

### 4.3 Main line

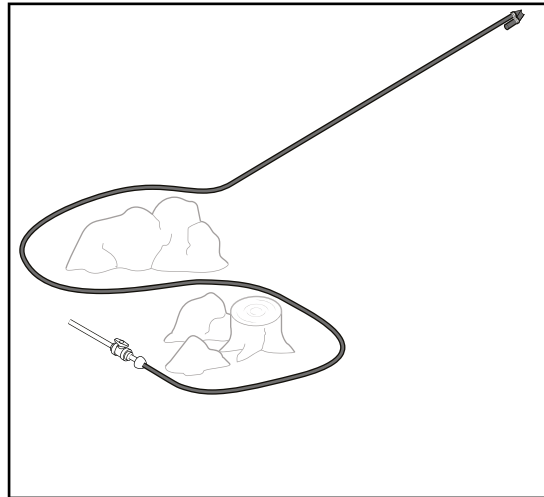

#### Connection of main line to main valve

- 1 Take another male adapter (A7), remove the cap and follow the above procedure to connect male adapter to the main line (A1), still on roll.
- 2 Screw male adapter (A7) to main valve (A4) and fasten it.

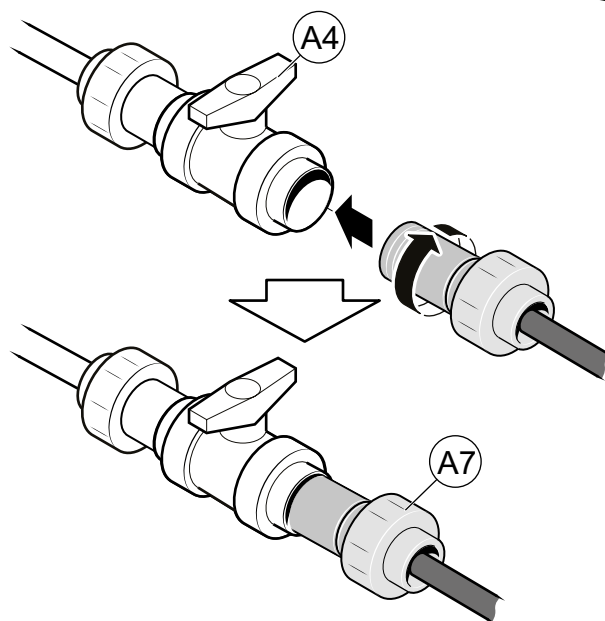
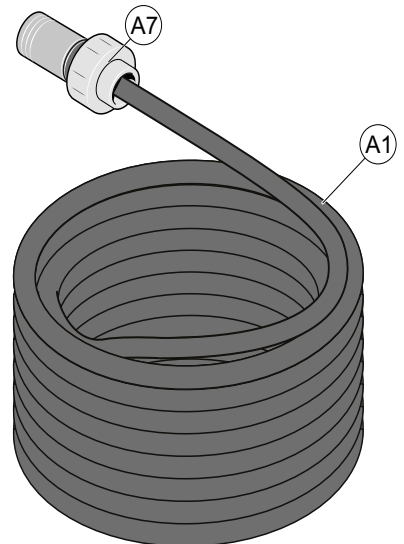

- 3 Roll out main line (A1) from main valve (A4) to the furthest END of the growing area (after last growing bed).

Make sure not to bend the main line.

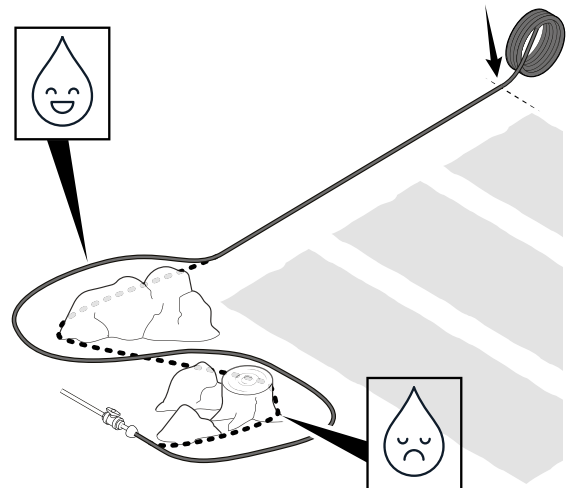

- 4 Cut main line at the very END of growing area, after last growing bed.

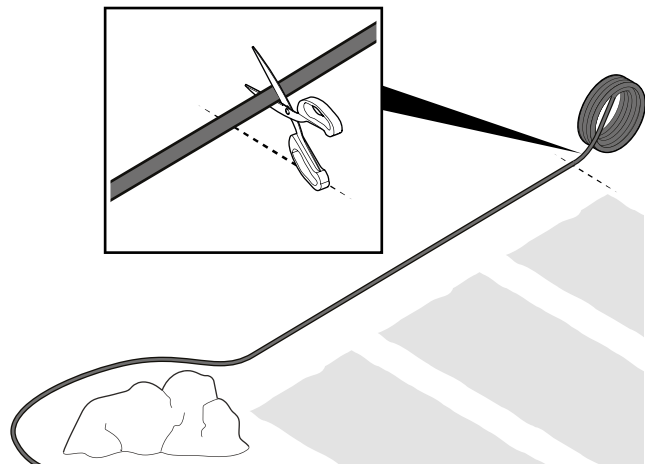

- 5 Attach Ø25mm main line stopper (A8) at end of main line. Put main line through one of holes, bend it and then put it back through other hole.

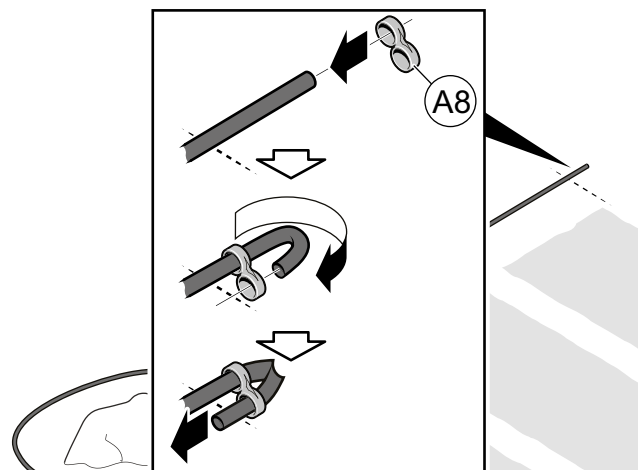

- 6 Make holes in main line for each drip line with Multi tool (A10).

Make holes halfway (45°) between top of main line and side fronting growing bed.

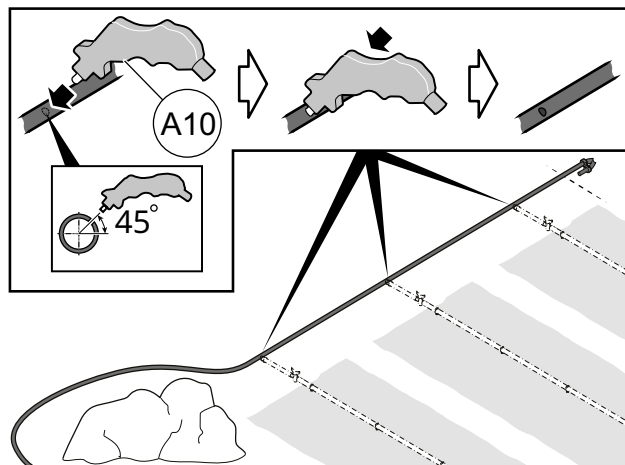

## 4.4 Drip line

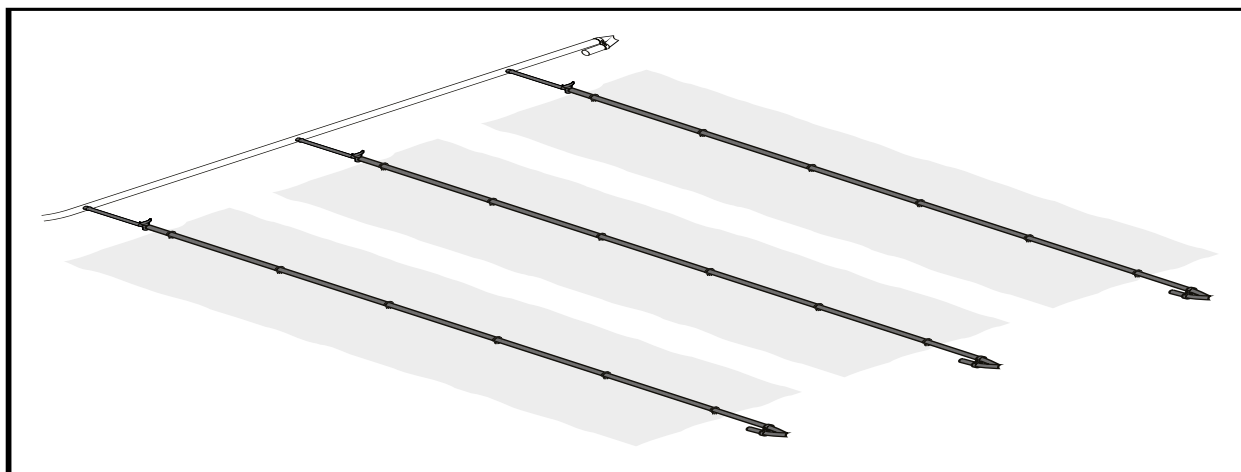

### Connection of drip line to main line

- 1 Push a drip connector (A3) into each of new hole in main line.

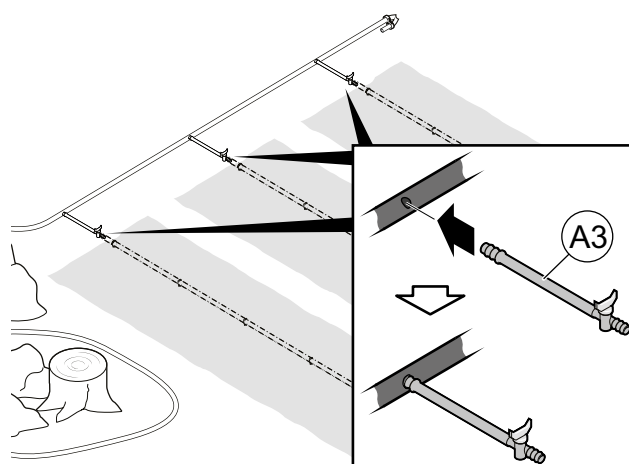

- 2 Roll out drip line (A2) from drip connector (A3) to end of growing bed and cut off drip line to same length.

Repeat for all growing beds along main line (A1).

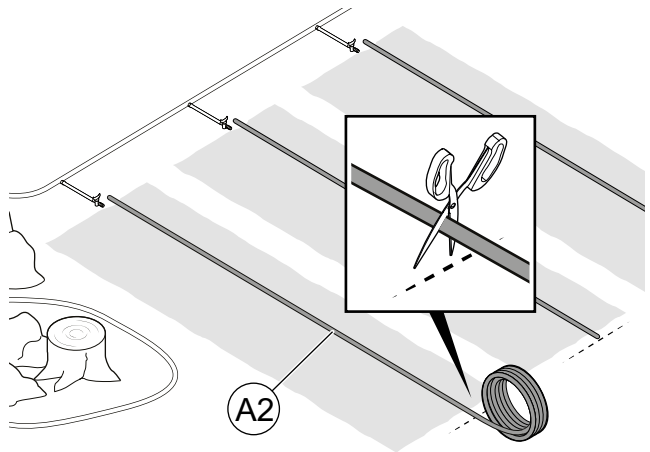

- 3 Connect a drip line to each drip connector.

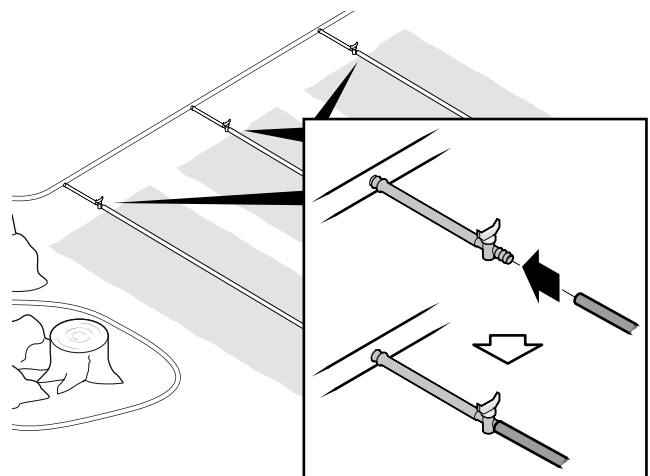

- 4 Attach Ø16mm stopper (A9) at end of drip line.

Put hose through one hole, bend it and then put it back through other hole.

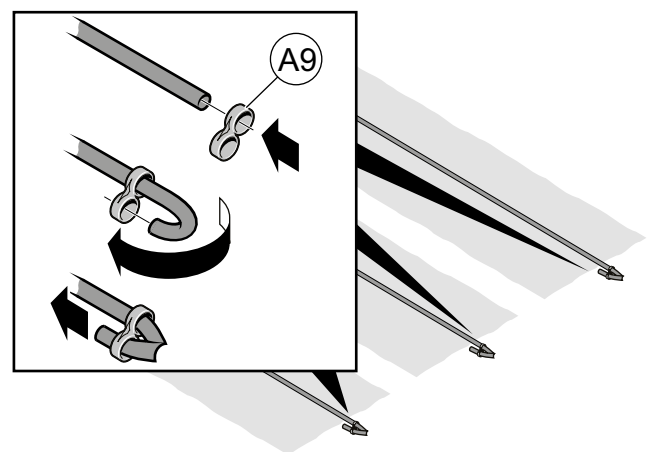

5 Mount drip holder pin (A11) along drip line in order to hold drip line in place.

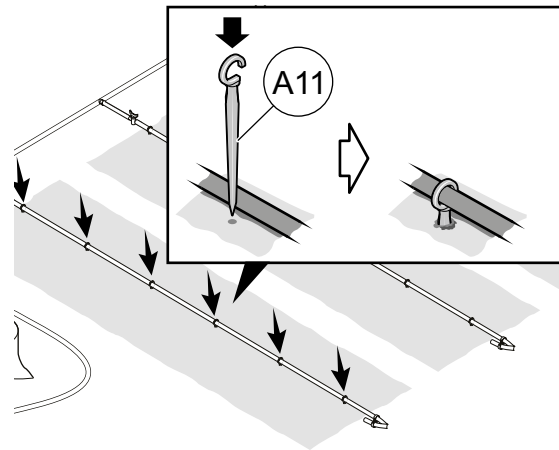

#### 4.4.1 Start the system

1 Open the valves of drip connectors.

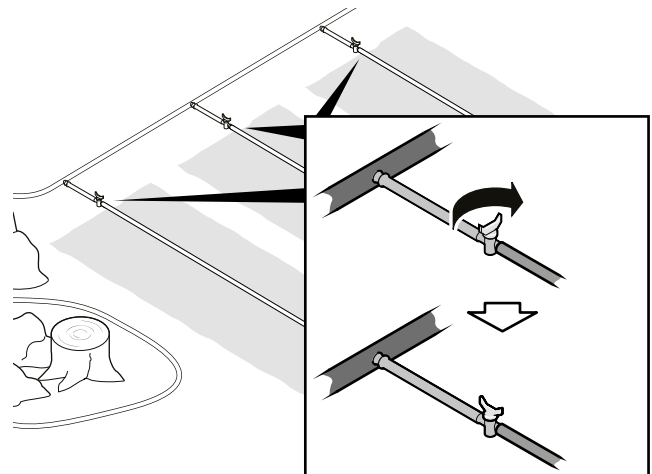

2 Open the main valve.

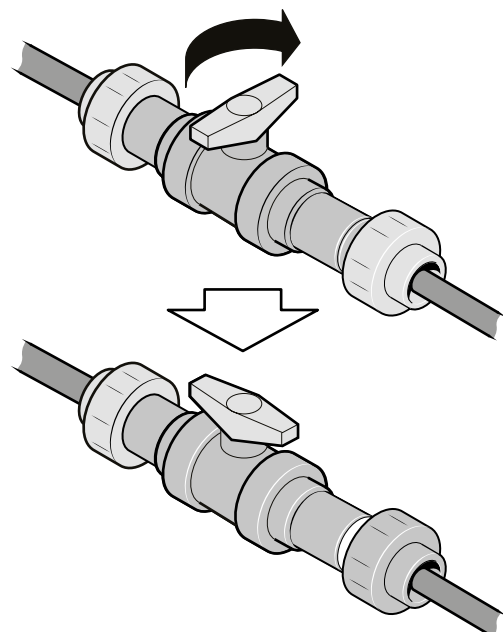

3 Turn ON power button (K) of the PMB.

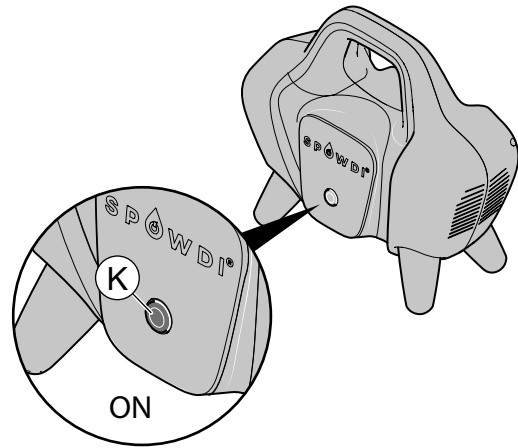

4 Operate the system for 5 minutes.

5 Check water is pouring out from drippers on drip line.

6 Drip installation is completed.

### **Note!**

1. Make sure there is no leakage in all connectors.
2. Check the water level in pressure vessel, if it is not on OK mark check the service manual chapter 3.2.3.1 (Pg.7) to adjust the air regulator screw.

**Spowdi AB**

Registration number: 559098-2954

Augustendalsvägen 7 (11 fl), 131 52

Nacka Strand, Sweden

[www.spowdi.com](http://www.spowdi.com) | [info@spowdi.com](mailto:info@spowdi.com)